



## CT160 Quick Guide

This Guide is intended for quick consultation only and does not replace the Use and Maintenance Manual. Before using the machine, read the Use and Maintenance Manual contained in the machine packaging thoroughly and rigorously respect all the instructions.

### PREPARATION/OPERATION

Fill the detergent tank.

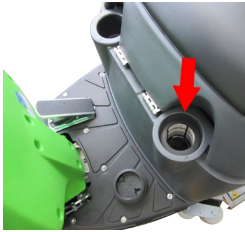

Raise the side flaps and insert the brushes under the head, making sure they rest against the aligners.

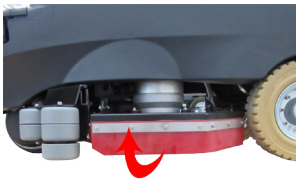

Turn the ignition key to switch the machine on.



To attach the brushes automatically, proceed as follows:  
Press the "Click-Off-On" button. The machine first performs a release operation, then immediately afterwards enables the attachment operation. Press the "Click-Off-On" button again to automatically attach the brushes.



Select the most suitable cleaning programme according to the surface and dirt to be removed:

P1: light cleaning programme  
P2: medium cleaning programme  
P3: heavy cleaning programme.

After the cleaning programme has been selected, the machine chooses the advance speed and quantity of detergent, then turns the suction and brush motors on.



The machine can be operated without using the 3 cleaning programmes provided by the manufacturer. In this case, the brush and suction motors must be turned on and the quantity of detergent regulated manually by pressing the buttons shown.



Choose the direction of movement by moving the direction selector. Select maximum speed by turning the potentiometer.



Press the Chem Dose system button (OPTIONAL).



Operate the machine movement pedal.



If necessary, release the service or parking brake.



Begin working.

When you have finished cleaning, proceed as follows:

- Turn the brush/suction motor off.
- Turn the ignition key.
- If necessary, charge the batteries.

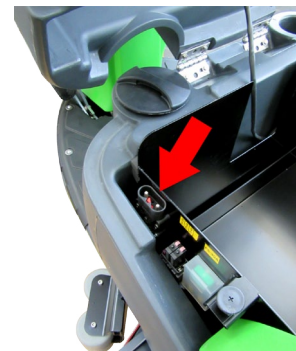



## DAILY MAINTENANCE

Empty the dirty water drum through the drain hose.



Clean the dirty water tank with water or water and detergent.



Check the suction filter is undamaged and clean.



Check the detergent output filter is undamaged and clean.



Clean the brushes.



Check the detergent tank fill filter is undamaged and clean.

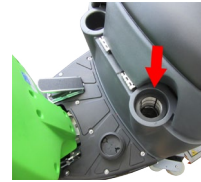

Check the squeegee is clean and the blades are not damaged.



Check the battery charge shown on the display. To charge, insert the battery charger connector in the connector under the seat.

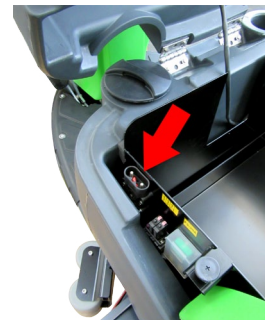

## REPLACING THE SQUEEGEE BLADES

Front:

- unscrew the screws fixing the blade retainer;
- remove the blade retainer;
- remove the blade;
- put the same blade back, reversing the edge in contact with the floor, or replace with a new one;
- reposition the blade retainer and fix with the screws;

Back:

- unscrew the screws fixing the blade retainer;
- remove the blade retainer
- remove the blade;
- put the same blade back, reversing the edge in contact with the floor until all four edges are worn, or replace with a new one;
- reposition the blade retainer and fix with the screws;

## AUTOMATIC BRUSH ATTACHMENT

Attaching:

Press the "Click-Off-On" button. The machine first performs a release operation, then immediately afterwards enables the attachment operation. Press the "Click-Off-On" button again to automatically attach the brushes.

Releasing:

Press the "Click-Off-On" button, the machine releases the brushes.

THE MACHINE DOES NOT COME ON/START UP	CHECK THE BATTERY CHARGE
THE SUCTION MOTOR DOES NOT WORK	CHECK THE DIRTY WATER DRUM IS NOT FULL CHECK THE DIRTY WATER DRUM LEVEL SENSOR IS NOT BLOCKED/MALFUNCTIONING
THE MACHINE LEAVES THE FLOOR WET	CHECK THE SQUEEGEE BLADES ARE NOT WORN CHECK THERE IS NO DEBRIS BETWEEN THE TWO SQUEEGEE BLADES CHECK THERE IS NO DEBRIS IN THE SUCTION HOSE CHECK THE SUCTION FILTER IS UNDAMAGED AND CLEAN CHECK THE DETERGENT TANK LID IS CLOSED CORRECTLY CHECK THE SUCTION HOSE IS CORRECTLY ATTACHED TO THE SQUEEGEE
THE MACHINE LEAVES THE FLOOR DIRTY	CHECK THE TYPE OF BRUSH/PAD IN USE IS SUITABLE FOR THE TYPE OF DIRT AND FLOOR
THE MACHINE LEAVES STRIPES OF WET FLOOR	CHECK THE FLOOR HAS BEEN BRUSHED BEFORE USING THE MACHINE CHECK THERE IS NO DEBRIS BETWEEN THE TWO SQUEEGEE BLADES CHECK THE SQUEEGEE BLADES ARE NOT WORN CHECK THE SQUEEGEE IS CORRECTLY ADJUSTED